



**TPS6-43-350/2700-01**

6dB Unequal Divider/Tapper



**Technical Features**

**PRODUCT DESCRIPTION**

RFS TPS\* Tapper product family has been designed to support a variety of wireless applications in the frequency band from 350 to 2700MHz. The units couple off a defined fraction of a RF signal from typically 5 to 30 dB with minimal reflections or loss. The broad frequency range is ideally suited for 3G / 4G multi-band distributed antenna systems or in combination with RADIAFLEX® radiating cables. Notably, these products feature a low level of network interferences due to their PIM optimized desing.



**FEATURES / BENEFITS**

- Broadband 350-2700MHz**
- 4.3-10-female interfaces
- PIM optimized design (163dBc @ 2x43dBm)
- Ideal for all kind of DAS applications
- Low insertion loss
- High power handling
- Small size, low weight

**TECHNICAL FEATURES**

**Electrical Specifications**

<b>Frequency Range</b>	MHz	350-2700
<b>Input Power</b>	W	300
<b>PIM 3rd @2*43 dBm</b>	dBc	160
<b>Input Impedance</b>	Ohm	50
<b>Max. VSWR / Return Loss</b>	VSWR / dB	1.2 @ 350-960MHz, 1800-2700MHz 1.3 @ 1710-1800MHz
<b>Insertion Loss max.</b>	dB	0.1

**Mechanical Specifications**

<b>Connectors</b>		4.3-10 Female
<b>Number of Input Ports</b>		1
<b>Number of Output Ports</b>		2
<b>Temperature Range</b>	°C	-25 to +75
<b>IP Level</b>		IP65
<b>RoHS</b>		Compliant
<b>Dimensions Height*Width*Length</b>	mm	89*32*32

**Model Number Specifications**

<b>Model Number</b>		TPS5-43-350/2700-01	TPS6-43-350/2700-01	TPS8-43-350/2700-01	TPS10-43-350/2700-01
<b>Coupling Value</b>	dB	5	6	8	10
<b>Coupling Flatness max.</b>	dB	± 1,0	± 1,0	± 1,2	± 1,2

**Model Number Specifications**

<b>Model Number</b>		TPS13-43-350/2700-01	TPS15-43-350/2700-01	TPS20-43-350/2700-01	TPS30-43-350/2700-01
<b>Coupling Value</b>	dB	13	15	20	30
<b>Coupling Flatness max.</b>	dB	+2,0 / -1,0			



**TPS6-43-350/2700-01**

6dB Unequal Divider/Tapper

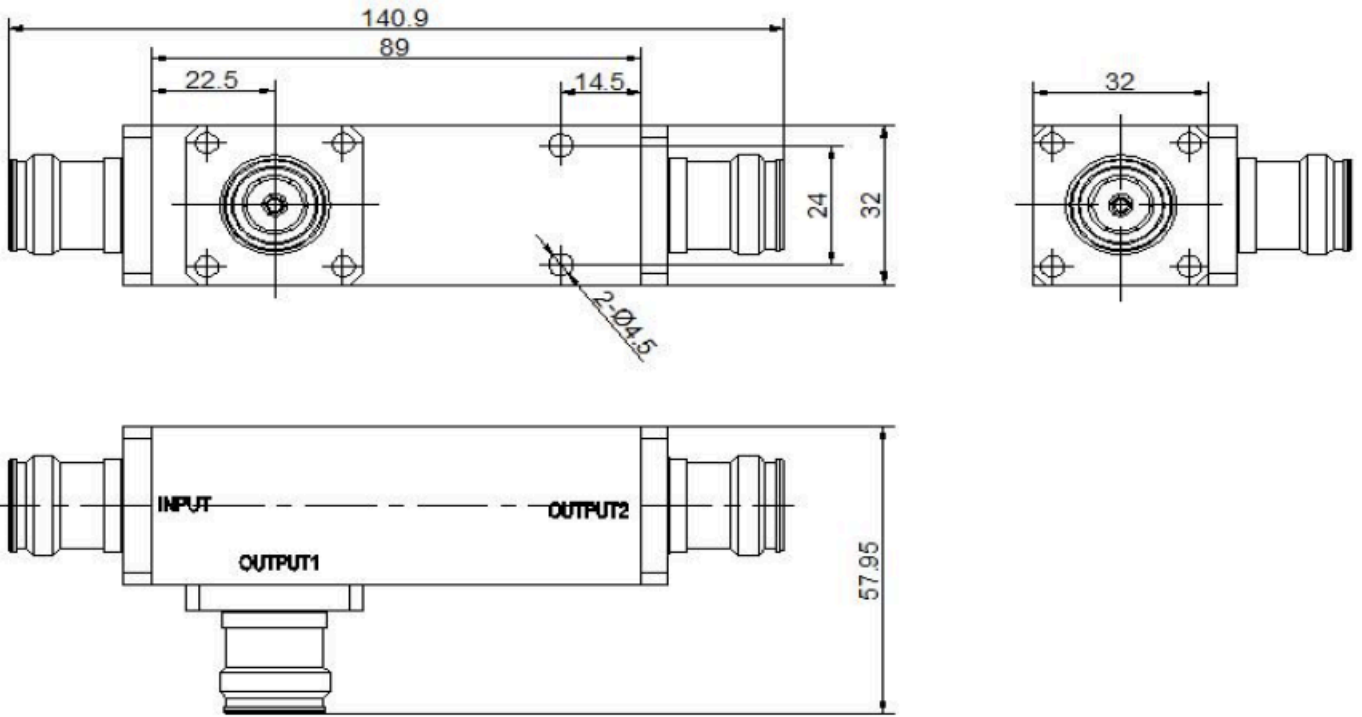

Product Drawing

[External Document Links](#)

[Notes](#)