



NMR-LCF12-E01

N Male Connector for 1/2" Coaxial Cable, OMNI FIT™ Premium, Right Angle, polymer claw and compression sealing

CELLFLEX® 1/2" low loss connector



Features / Benefits

OMNI FIT™ E02 high-performance connectors are engineered for use with both CELLFLEX® (copper) and CELLFLEX® Lite (aluminum) cables. They ensure a superior connector-to-cable interface while enabling fast, simple, and reliable installation. All RFS connectors are rigorously tested to meet and exceed industry standards for mechanical and electrical performance. Reliable environmental sealing is achieved via an integrated O-ring, protecting both the outer conductor and cable jacket.

- **Ultra-high PIM performance**
Minimizes passive intermodulation, reducing signal interference and improving network quality
- **Two-piece connector design**
Allows visual inspection of the interlock mechanism, ensuring secure and error-free installation
- **OMNI FIT™ concept**
Simplifies ordering processes and reduces inventory complexity
- **Watertight sealing (in mated condition)**
Enhances environmental protection, reducing installation effort and ensuring long-term operational reliability
- **Outstanding corrosion resistance**
Ensures durability and performance even in harsh climatic and environmental conditions

Technical Features

STRUCTURE

Cable Type	LCF	
Cable Size	1/2"	
Qualified Cable Types	LCF12-50J / JFN	LCF12-50J / JFN-ECO
Model Series	E01 Premium Series	
Connector Interface Size	N	
Connector Interface Gender	Male	

MECHANICAL SPECIFICATIONS

Connector Length	69.05mm (2.718in)
Connector Outer Diameter	29mm (1.142in)
Inner Conductor Material / Coating	Copper Alloy / Silver Plated
Outer Conductor Material / Coating	Copper Alloy / Trimetal Plated
Insulation Material	PTFE / TPX
Sealing Method	O-Ring



NMR-LCF12-E01

N Male Connector for 1/2" Coaxial Cable, OMNI FIT™ Premium, Right Angle, polymer claw and compression sealing

ELECTRICAL SPECIFICATIONS

Nominal Impedance	50 Ω	
Connector Frequency Range	DC - 6.0 GHz GHz	
PIM Ratio (2 x 20 W Carrier)	≤ -156 dBc	
PIM ratio Typical (2 x 20 W Carrier)	≤ -162 dBc	
Frequency Range	VSWR	Return Loss
0 < f ≤ 1.0 GHz	1.04	34
1.0 < f ≤ 2.2 GHz	1.06	31
2.0 < f ≤ 2.7 GHz	1.08	28
2.7 < f ≤ 3.8 GHz	1.11	26
3.8 < f ≤ 5.0 GHz	1.15	23
5.0 < f ≤ 6.0 GHz	1.22	20

TESTING AND ENVIRONMENTAL

Ingress Protection (IP) Rating	IP68
--------------------------------	------

ACCESSORIES

Wrench Size Connector Interface	19mm (0.748in)
Wrench Size Connector Front Part	22mm (0.866in)
Wrench Size Connector Rear Part	22mm (0.866in)
Trimming Tool	TRIM-SET-L12-D01

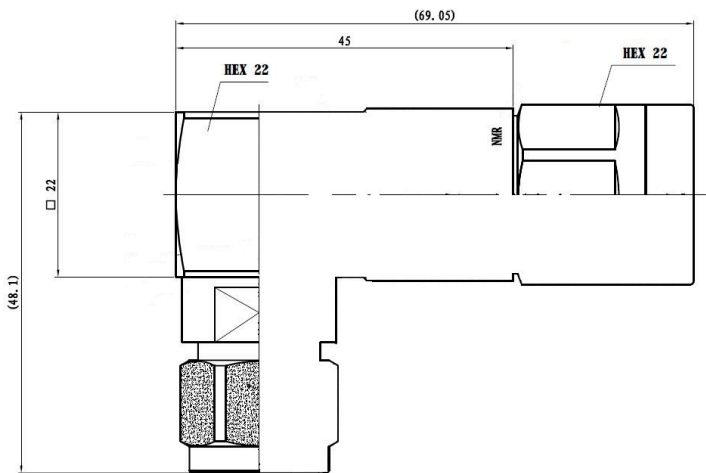

Related Documents

Installation Instruction
Installation Instructions